



“The “HUB” that enables resiliency in healthcare”

Thank You to Our Sponsors

The Canadian Healthcare Engineering Society and the 2019 Organizing Committee gratefully acknowledge the generous contributions and financial support of our sponsors.



CANADIAN COLLEGE OF
HEALTH LEADERS
COLLÈGE CANADIEN DES
LEADERS EN SANTÉ

MAINTENANCE OF CERTIFICATION

Attendance at this program entitles certified Canadian College of Health Leaders members (CHE / Fellow) to **4.5 Category II credits** towards their maintenance of certification requirement.



PROFESSIONAL DEVELOPMENT

This program entitles attendees to **0.1 CEU's per hour of Education Programing attended**. These CEU's can be applied to the maintenance of certification requirement for CCHFM & Canadian Healthcare Construction Course Certificate renewals.

CHES 2019 MINUTE BY MINUTE

Friday, September 20, 2019			
1300-1700	CHES Board of Directors Meeting	HIDH	Cosmopolitan Room,
1900-2200	CHES Board Dinner	Offsite	Western Development Museum
Saturday, September 21, 2019			
0800-1230	CHES Strategic Planning Meeting	HIDH	Cosmopolitan Room,
1400-1700	CHES ON Chapter Executive Meeting	HIDH	Hilton Hotel
Sunday, September 22, 2019			
0600-1100	Decorator Set-Up	TCU	Grand Salon
0800-1400	The Great CHES Golf Game	Offsite	Moon Lake Golf Club
0830-1200	CHES BC Chapter Executive Meeting	TCU	Regal A
0930-1600	Companion Program	TCU	Pick up in the Lobby of the TCU
1100-1700	Exhibitor Set-Up	TCU	Grand Salon
1100-1800	Registration – Sponsors/Exhibitors/Delegates	TCU	Registration/Coat Check
1830-2030	Registration	Offsite	Remai Modern Art Gallery
1830-2030	Opening Reception	Offsite	Remai Modern Art Gallery
Monday, September 23, 2019			
0630-1700	Registration	TCU	Registration/Coat Check
0700-0830	Committee Meetings, Communications, P & A, PD	TCU	Gallery CD
0700-0830	Delegate Breakfast	TCU	Gallery CD
0830-0845	Opening Ceremonies	TCU	Gallery AB
0845-0930	Keynote Address – <i>Mark Black</i>	TCU	Gallery AB
0930-1030	Track 1 – Forging a Path to Resiliency: Using CSA Z8002 to Increase the Capacity to Respond to Operational Disturbances – <i>Steve McEwan; Robert Barss</i>	TCU	Gallery AB
0930-1500	Companion Program	TCU	Pick up in the Lobby of the TCU
1000-1700	Exhibit Hall Open	TCU	Grand Salon
1030-1100	Refreshment Break	TCU	Grand Salon
1100-1200	Track 2A – Benefits of Using RETScreen Clean Energy Management Software in Health Care – <i>Kevin Bourque; JJ Knott</i>	TCU	Gallery A
1100-1200	Track 2B – The Building Envelope: Keeping the Water Out – <i>Gord Rajewski</i>	TCU	Gallery B
1200-1300	Track 3A – CSA Healthcare Standards: How Compliant Are You? – <i>George Pankiw</i>	TCU	Gallery A
1200-1300	Track 3B – Deciphering Electric Lighting Technology – <i>Alison White</i>	TCU	Gallery B
1300-1400	Lunch in Exhibit Hall	TCU	Grand Salon
1200-1300	CHES Corporate/Associate Member Advisory Council	TCU	Gallery Suite 1
1300-1400	CHES 2020 CPC Meeting	TCU	Gallery Suite 1
1500-1600	Track 4A – CSA Z7396.1-17 Medical Gas Pipeline Systems: A need to know discussion – <i>Roger Holliss; Alan Pinkerton</i>	TCU	Gallery A
1500-1600	Track 4B – Finding the Sweet Spot in Long Term Care - <i>Jerold Peters; Chris Ott; Chris Hewitt</i>	TCU	Gallery B
1600-1700	Happy Hour!	TCU	Grand Salon
1800-1900	President's Reception	TCU	Centennial Hall ABC
1900-2300	Gala Banquet	TCU	Centennial Hall ABC

TCU = Saskatoon Convention Centre, TCU Place
HI = Holiday Inn Downtown Hotel

CHES 2019 MINUTE BY MINUTE (continued)

Tuesday, September 24, 2019			
0630-1700	Registration	TCU	Registration/Coat Check
0700-0830	Committee Meetings, Membership	TCU	Gallery CD
0700-0830	Delegate Breakfast	TCU	Gallery CD
0830-0900	CHES Board/Exhibitor Meeting	TCU	Gallery Suite 1
0830-0930	Track 5A – Fire Safety Evaluation Systems and Their Role in Asset Management – <i>Ben Coles</i>	TCU	Gallery AB
0830-0930	Track 5B – Disrupting the Building and Infrastructure Industry – <i>Sunny Ghataurah</i>	TCU	Gallery AB
0930-1015	CHES National AGM	TCU	Gallery A
1015-1045	CHES SK Chapter AGM	TCU	Gallery A
1015-1100	CHES Maritime Chapter Executive Meeting	TCU	Gallery Suite 1
1015-1045	Refreshment Break in Exhibit Hall	TCU	Grand Salon
1015-1315	Exhibit Hall Open	TCU	Grand Salon
1100-1130	2019 and 2020 CHES CPC/Board Meeting	TCU	Gallery Suite 1
1200-1315	Lunch in Exhibit Hall and Prize Draw	TCU	Grand Salon
1315-1415	Track 6A – Co-generation as a Resiliency Measure – <i>John Karman</i>	TCU	Gallery A
1315-1415	Track 6B – The “Heart” of Hospital Comfort – Improving Resiliency by Understanding Flow – <i>Yves Lemoine</i>	TCU	Gallery B
1330-1800	Exhibit Tear-Down	TCU	Grand Salon
1415-1515	Track 7A – The Importance of Building an IPAC Culture to Improve Patient Care and Outcomes – <i>Craig Yee</i>	TCU	Gallery A
1415-1515	Track 7B – Developing an Effective Scope of Work (SOW) for Operations and Service Contracts – <i>Jake Smithwick</i>	TCU	Gallery B
1515-1545	Refreshment Break	TCU	Gallery AB Foyer
1545-1645	Track 8 – The National Trend Toward Prompt Payment – How Will This Impact Consultants? – <i>Misty Alexandre; Jared Epp</i>	TCU	Gallery AB
1645-1700	Closing Ceremonies	TCU	Gallery AB
1730-1830	CHES Board Meeting	TCU	Gallery Suite 1

TCU = Saskatoon Convention Centre, TCU Place
HI = Holiday Inn Downtown Hotel

CHES 2019 ORGANIZING COMMITTEE

CO-CHAIRS

Jim Allen
Steve Kemp

Steering Committee

Jim Allen (Co-Chair)
Steve Kemp (Co-Chair)
Peter Whiteman
Melodie Young
Carol Cole
Christa Brown
Kent Waddington
Roger Holliss (CHES Vice President)

Exhibits & Sponsorships Committee

Reynold Peters (Chair)
Peter Jarvis (Co-Chair)
Kent Waddington (Green Park Chair)

Social Committee & Golf

Jim McArthur (Chair)
Carol Cole (Co-Chair)
Melodie Young

Program Committee

Peter Whiteman (Chair)
Gordon Burrill
Guy Fehr
JJ Knott
Peter Jarvis
Kent Waddington

Communications & Promotion Committee

Jim Allen
Steve Kemp
Sarah Seward
Donna Dennison

Conference Office

Donna Dennison, CHES Executive Director
Sarah Seward, Conference Coordinator

Follow Us
[@CHES_SCISS](https://twitter.com/CHES_SCISS)



Use Hashtag
[#2019CHES](https://twitter.com/hashtag/2019CHES)



OFFICE OF THE MAYOR

It is my pleasure to welcome everyone attending the Annual National Conference for the Canadian Healthcare Engineering Society to Saskatoon, located in the heart of Treaty 6 and the Homeland of the Métis Nation. It is wonderful to have delegates from throughout the country staying with us in our community.

I wish all of the attendees the best over the coming days as you seek to learn from and with one another about the latest trends in healthcare engineering. This is such an important part of people's interaction with the healthcare system both as patients and as visitors.

To all of those visiting Saskatoon, I hope that you are able to enjoy all that our community has to offer. Saskatoon is the home of the beautiful Meewasin river valley, the Rемаi Modern Art Gallery of Saskatchewan, and is just a short trip to the Wanuskewin Heritage Park. We have a growing restaurant scene and many unique stores and shopping districts that are well worth a visit. I invite you to explore our vibrant city, and—above all else—to experience the warmth and hospitality from the great citizens of our community.

On behalf of my colleagues on City Council, I hope that you have an enjoyable stay in our community and an engaging time at this conference.

A handwritten signature in black ink, appearing to read 'Charlie Clark'.

Charlie Clark
Mayor

PRESIDENT'S MESSAGE



On behalf of the National Board and the Executive team, I am pleased to officially welcome you to Saskatoon, Saskatchewan. This is our 39th Annual Conference of the Canadian Healthcare Engineers Society and this year's Educational Program will elaborate on the theme, "The HUB That Enables Resiliency in Healthcare".

The keynote speaker for the event is Mark Black whom I have heard speak previously and his life journey is amazing. HIS story IS the pinnacle of resilience.

The organizing committee has selected a great group of exhibitors and sponsors to whom are ready and willing to discuss new advances in their selected field. I encourage you to visit with as many of these individuals as you can. I would also like to recognize our corporate sponsors. Without their continued support and generosity, it would be extremely difficult to host such an outstanding event.

There are a multitude of educational sessions throughout the conference. Presenters were specifically selected to speak on topics relating to our theme. Thank you for your involvement.

I would like to thank the planning committee, the chairs Jim Allen & Steve Kemp and committee chairs: Peter Whiteman/Jim McArthur/Reynold Peters/Carol Cole/Kent Waddington and executive liaison Roger Holliss. I would also like to thank Donna Dennison and Sarah Seward from our National Office for overseeing and coordinating the conference.

In closing, I would like to thank each one of you for participating in this event and for making the Canadian Healthcare Engineers Society a viable organization. Thank you to the Senior Management of your respective organizations for allowing you to attend. It is important to take the time to show them what you have found and how it can positively impact operations at your site, facility or region. We are all striving to continue our efforts to make positive changes that impact our patients, visitors, public and co-workers.

Take the time to network and enjoy the hospitality of our hosts.

Mark your calendars for the upcoming National Conference in 2020 hosted by the Maritime Chapter in Halifax Nova Scotia on September 20-22, 2020 at the Halifax Convention Centre.

Respectfully,
Preston Kostura
CHES National President

CHES BOARD OF DIRECTORS – 2019-2020

President	Preston Kostura
Vice President	Roger Holliss
Past President	Mitch Weimer
Secretary	Kate Butler
Treasurer	Craig Doerksen
Alberta Chapter Chair	Dan Ballantine
British Columbia Chapter Chair	Norbert Fischer
Manitoba Chapter Chair	Tom Still
Maritime Chapter Chair	Helen Comeau
Newfoundland Chapter Chair	Colin Marsh
Ontario Chapter Chair	Jim McArthur
Quebec Chapter Chair	Mohamed Merheb
Saskatchewan Chapter Chair	Greg Woitas
Executive Director	Donna Dennison

CHES COMMITTEES

CHES Membership Committee Chair	Gordon Jackson
CHES Communications Committee Chair	Larry Erwin
CHES Professional Development Committee Chair	Robert Barss
CHES Canadian Healthcare Construction Course Subcommittee	Steve McEwan
CHES Medical Gas Piping Systems Course	Jeff Smith
CHES Conference Planning Team 2019	Jim Allen/Steve Kemp
CHES Conference Planning Team 2020	Robert Barss
CHES Governance Committee Chair	Preston Kostura
CHES Partnerships & Advocacy Chair	Richard White
CHES Healthcare Standards Subcommittee Chair	Gordon Burrill
CHES CCHFM Advisory Panel	Robert Barss
CHES Corporate Advisory Council	Christa Brown

GENERAL INFORMATION

CONFERENCE LOCATIONS

Trade Show	Grand Salon, Saskatoon Arts & Convention Centre, TCU Place
Sessions	Keynote/Plenary's - Gallery AB, Saskatoon Arts & Convention Centre, TCU Place Tracks – Gallery A / Gallery B Saskatoon Arts & Convention Centre, TCU Place
Registration	Registration/Coat Check, Saskatoon Arts & Convention Centre, TCU Place
Breakfast	Gallery CD, Saskatoon Arts & Convention Centre, TCU Place

TRADE SHOW HOURS

Monday, September 23, 2019	1000-1700 (Grand Salon, Saskatoon Arts & Convention Centre, TCU Place)
Tuesday, September 24, 2019	1015-1315 (Grand Salon, Saskatoon arts & Convention Centre, TCU Place)

REGISTRATION DESK HOURS

Sunday, September 22, 2019	1100 – 1800 (Registration/Coat Check – all attendees) 1830 – 2000 (Remai Modern Art Gallery – all attendees)
Monday, September 23, 2019	0630 – 1700 (Registration/Coat Check– all attendees)
Tuesday, September 24, 2019	0630 – 1500 (Registration/Coat Check – all attendees)

REGISTRATION SPONSORS & GIFTS

- ❖ Conference Bags *Sponsored by CHES SK*
- ❖ Conference App *Sponsored by Daikin Applied.*
- ❖ Mobile Recharge Station *Sponsored by Flynn*
- ❖ Lanyards *Sponsored by Stantec Consulting*
- ❖ Official Time *Sponsored by Primex Wireless*
- ❖ Student Program *Sponsored by H. H. Angus*

PLATINUM SPONSOR
PLATINUM SPONSOR
GOLD SPONSOR
SILVER SPONSOR
SILVER SPONSOR
SILVER SPONSOR

PLEASE NOTE

Name Badge: Delegates are required to wear their name badge to all conference functions including access to the Tradeshow Floor and Education sessions.

Social Events & Meals: Applicable tickets for meals and social events will be in your registration packages and will be collected at each function. Additional tickets are available to purchase at the Registration Desk.

DOWNLOAD THE CHES 2019 APP!

APP Download Instructions

iPhone and iPad users: To access the CHES Events app on your iOS device, please search **GatherNow by Certain** and install or click this link on your device: <https://apps.apple.com/us/app/gathernow-by-certain/id1301552692>

Open app, tap Search button at the bottom of main screen. Enter CHES Events. Tap CHES Events in the results to add it to your home screen and select **39th Annual Conference of the Canadian Healthcare Engineering Society**

Android users: To access the CHES Events app on your Android device, search CHES Events on the Google Play store or click this link on your device:

<https://play.google.com/store/apps/details?id=org.ches.gd.events>

Blackberry, Windows, laptop users: To access the mobile web version go to <https://chesevents.gatherdigital.com> (omit the www)

Logging into the App



National Facilities & Healthcare Engineering Week

OCTOBER 20 – 26, 2019





SAVE THE DATE!

The CHES 2020 National Conference will be held in Halifax NS at the **Halifax Convention Centre**, September 20-22, 2020. The Halifax Convention Centre is conveniently located in the downtown core and close to local amenities.

A block of rooms has been reserved at the both the **Cambridge Suite Hotel**, starting at \$199 plus applicable taxes single/double occupancy and the **Prince George Hotel** starting at \$239 plus applicable taxes single/double occupancy

The theme of the 2020 conference is
“Enriching Patient Experiences by Optimizing the Environment”

The CHES 2020 Education Program is well underway and will once again feature dual tracks with talks on relevant industry topics from high-profile experts in the field. We have booked **Alan Mallory** as our **Keynote Speaker**. Alan is a dynamic keynote with a talk built around two years of planning and two months of climbing that went into making the goal of reaching the summit of Mount Everest a reality. Alan will discuss focusing on results rather than tasks, being agile so we can adapt to change, overcoming adversity through resilience, building trust in professional relationships, adopting an iterative approach.

The Great CHES Golf Tournament will be held at **Glen Arbor Golf Course** on Sunday September 20, 2020.

Join us for the **CHES President’s Reception and Gala Banquet again in 2020** at Pier 21. The banquet will celebrate the accomplishments of our peers with the 2020 Awards presentations, while enjoying great food and entertainment with friends.

See you in 2020 in Halifax!

For more info visit our website at

www.ches.org

Follow us on Twitter!



@CHES_SCISS

Saskatoon Arts & Convention Centre, TCU Place

Main Floor

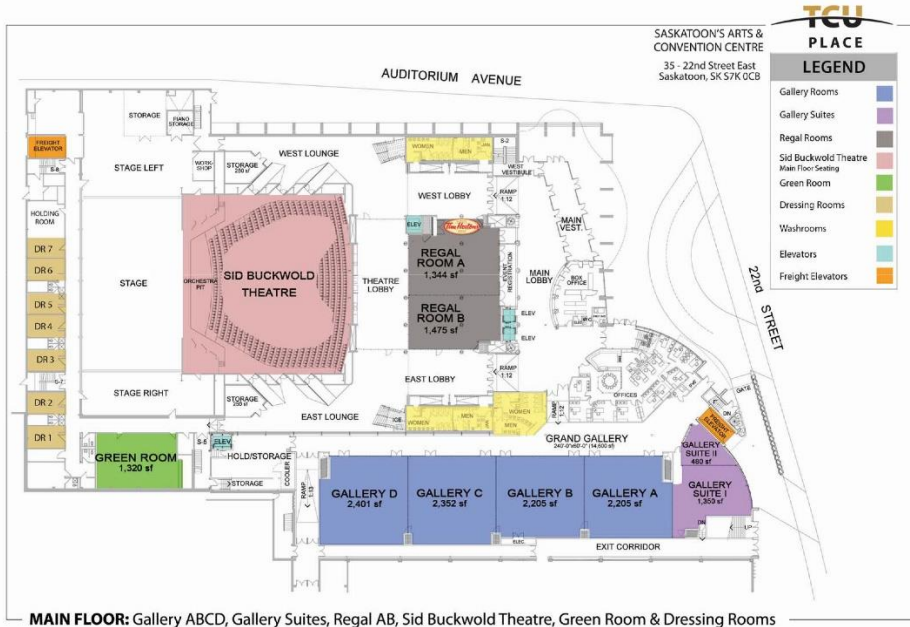

Upper Floor

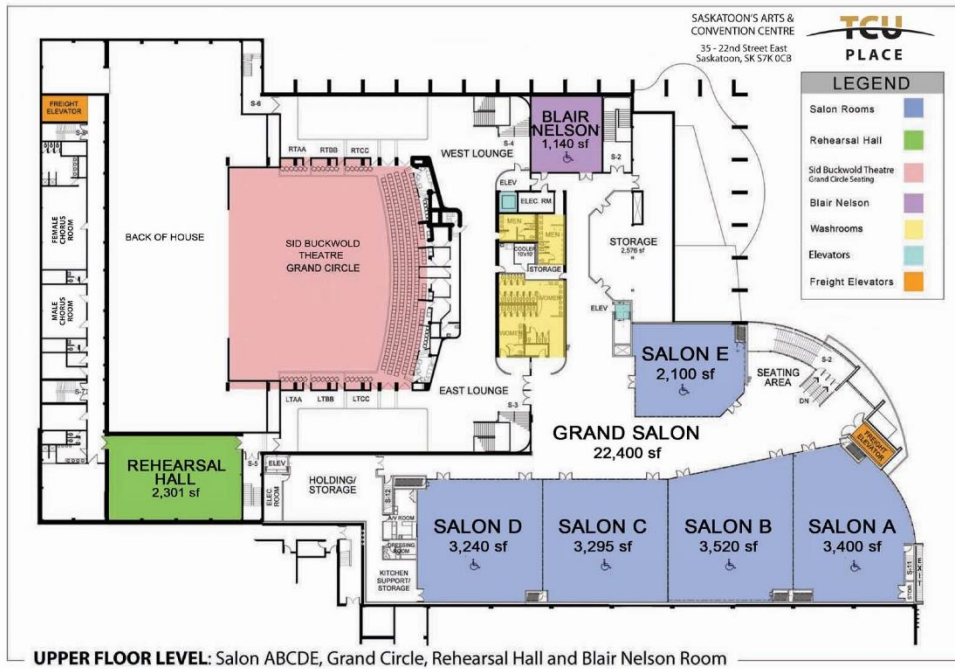

CHES TRADE SHOW BOOTHS

Grand Salon

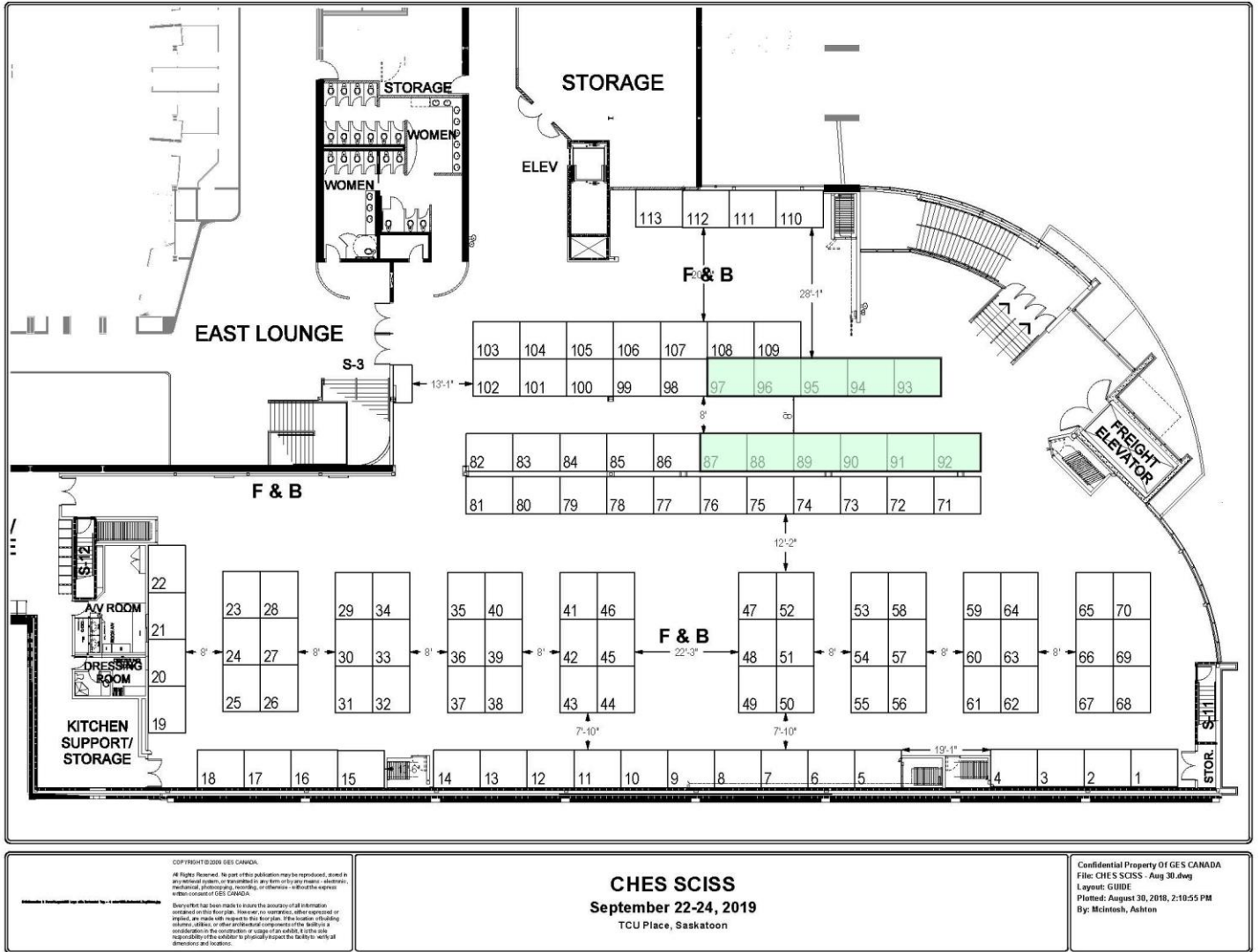

CHES TRADE SHOW BOOTHS

Grand Salon, Saskatoon Arts & Convention Centre, TCU Place

93/94 ♦ GP	Abatement Technologies Ltd.
41 ♦	Acklands-Granger Inc.
106	Air Liquide Healthcare
110	Altro Canada Inc.
103 ☉	AMG Medical
100	Aqua Air Systems Ltd.
40 ♦ ☉	AquaAnalytics
9 ♦	Armstrong Fluid Technology
64	Ascom
109	Atlas-Apex Roofing (Saskatchewan) Inc.
58	Austco Communication Systems
88 ♦ GP	Belimo Air Controls (CAN) Inc.
56 ☉	Bender Canada Inc.
25	BGE Indoor Air Quality Solutions Ltd.
15	Buckworld Western
10 ♦	Camfil Canada Inc.
97 GP	Canadian Coalition for Green Health Care
5	Canature WaterGroup
12	Casterland/Caster Town
39	CHAIR
45/46 ♦	CHEM-Aqua Canada
44	CHES / CHES 2020
47/ 48 ♦ ☉	Class 1 Inc.
89 GP ☉	Construction Specialties Inc.
53	Cool Air Rentals
18	CSA Group
11	Cypress Sales Partnership
54	Dafco Filtration Group
50 ☉	DDC Dolphin Ltd.
51	Delta Controls Inc.
19	Delta Faucet Canada
111	ECNG Energy Group
6	Energy in-hybrid Solutions Inc.
57	ENGIE
29	Erv Parent
27	ESC Automations Inc.
4	Evcor Solutions Inc.
14	Finning Power Systems
55	Firestop Contractors International Association (FCIA)
22	FlashCove Canada
61	Flatland Inspection Services Ltd.
49 ♦	Flynn Canada Ltd.
32	Follett LLC
7	Forbo Flooring Systems
43 ☉	Franke Kindred Canada Limited
104	Global Plasma Solutions Inc.
95/96 GP	Grundfos
31	Guard RFID Solutions Inc.
2	Hazmasters Inc.
84	Heritage Parts Canada
38 ☉	Hippo CMMS

92 ♦ GP	Honeywell
71 ♦ ☉	IEM Industrial Electric Mfg. (Canada) Inc.
20	Infection Control Training Group
62	ipcGUARD LTD
107	IRC Building Sciences Group
26	Islandaire
76/77 ♦	Johnson Controls
1	Lajcon Distributors
82/83	Levitt-Safety
21	Marathon Institutional Products Limited
68	MediaEdge Communications Inc.
36	Megamation Systems Inc.
69	Merlin Instrumentation
112/113	MIP Inc.
86 ☉	Miura Canada Co. Ltd,
99	Mondo Contract Flooring
28	Morris Lee
16	OES Wellness Group
33	On2 Solutions
37	Pinchin Ltd.
35 ♦	Precise Parklink Inc.
87 GP	Precision AirConvey Waste & Linen Conveying Group
8	Prescientx
98 ♦	Primex, Inc.
24	Rauland
90 GP	Reliable Controls Corporation
80 ♦ ☉	Reliance Worldwide Corporation (Canada) Inc.
70	SALTO Systems
85	Saskatchewan Masonry Institute Inc.
101/102 ☉	Schneider Electric Canada Inc.
105	SciCan Ltd.
67	Smillie McAdams Summerlin Ltd.
63	Specified Technologies Inc.
13	Steam Specialty Sales
108	STERIS Canada Sales ULC
23	Swisslog Healthcare
3	T & T Power Group
42	Texcan, A sonepar Company
52 ♦	Thermal Insulation Association of Canada
78/79 ♦	Thermogenics
81 ♦	Trane
34 ♦	Tremco
59/60	Umano Medical
91 GP	Vernacare Canada Inc.
74/75	Victaulic
17	Viega LLC
66	WD Industrial Group
72/73	WESCO Distribution Canada
65	Willis/Corian Design
30	Window Film Canada

☉ Company is an Industry Partner on the CHES web page.
 ♦ Company is a Conference Sponsor
 GP Booth in the Green Park

SUNDAY, SEPTEMBER 22, 2019

GOLF TOURNAMENT

0800-1400

Moon Lake Golf Club

Meet at the Lobby of the Holiday Inn Downtown Hotel / Hilton Garden Downtown Hotel at 7:30AM

COMPANION PROGRAM

1000-1600

Sponsored by *LEM SILVER SPONSOR*

Bus Pickup – Meet in the Lobby of the Saskatoon Arts & Convention Centre, TCU Place at 9:00 AM

CANADIAN LIGHT SOURCE TOUR

Group 1 – 10:15 AM | Group 2 – 11:15 AM

Bus Pickup – Meet in the Lobby of Saskatoon Arts & Convention Centre, TCU Place at:
Group 1 - 10:00 AM | Group 2 – 11:00 AM

OPENING RECEPTION

1830-2030

Remai Modern Art Gallery

Sponsored by *Class 1 Inc. PLATINUM SPONSOR*



Building Better Healthcare™

Reception Entertainment – Don Griffith

Sponsored by *Precise Parklink SILVER SPONSOR*

Bus Pickup – Meet in the Lobby of the Holiday Inn Downtown Hotel / Hilton Garden Downtown Hotel at:
Loop 1: 6:00 PM
Loop 2: 6:15 PM

MONDAY, SEPTEMBER 23, 2019

0700-0830 Delegate Breakfast
Sponsored by Thomson Power Systems GOLD SPONSOR Gallery AB (TCU)

1000-1700 TRADESHOW OPEN Grand Salon (TCU)

0930-1600 **COMPANION PROGRAM**
Sponsored by IEM SILVER SPONSOR Offsite

Bus Pickup – Meet at the Lobby of the Saskatoon Arts & Convention Centre, TCU Place immediately following the Keynote at 9:30 AM

0820-0845 **OPENING CEREMONIES**

WELCOME

Gallery AB (TCU)

Elder Roland Duquette, brings blessings and welcomes CHES on behalf of the First Nations & Métis people.

Preston Kostura, President, Canadian Healthcare Engineering Society, Alberta Health Services, Camrose AB

Jim Allen, Vice President, Five Hills Health Region, Moose Jaw, SK

Steve Kemp, Vice President, Ritenburg & Associates, Regina, SK

0845-0930 **KEYNOTE ADDRESS** *Sponsored by Honeywell KEY SPONSOR*

KEYNOTE ADDRESS – The Resilience Roadmap

Gallery AB (TCU)

Speaker: **Mark Black**, Fredericton, NB

Moderator: **Jim Allen**, Vice President, Five Hills Health Region, Moose Jaw, SK
Steve Kemp, Vice President, Ritenburg & Associates, Regina, SK

Introduction: **Luis Rodrigues**, Vice President, Energy Solutions, Honeywell Limited, Toronto ON

CCHFM Core What if life and work are supposed to be hard?

Competency: What if living a meaningful life was never meant to be easy? AND

Administration: What if, whether you realize it or not, that's actually a good thing?

If your people are struggling to cope with the fast pace of change, the Resilience RoadMap is the program you need.

In this presentation Mark provides the strategic framework your organization needs to develop Radical Resilience in your people. This program will help you:

- Decrease employee absenteeism
- Eliminate excuses and whining
- Increase productivity
- Improve morale
- Enhance company culture

0930-1030 **TRACK 1**

Forging a Path to Resiliency: Using CSA Z8002 to Increase the Capacity to Respond to Operational Disturbances

Gallery AB (TCU)

Speakers: **Steve McEwan**, Director, Plant and Maintenance Services, Interior Health BC
Robert Barss, CET, CCHFM, CHFM, Manager, Environmental Stewardship, Nova Scotia Health Authority, NS

Moderator: **Gordon Burrill**, President, Teegor Consulting Inc., Fredericton, NB

MONDAY, SEPTEMBER 23, 2019

CCHFM Core Competency: Maintenance & Operations	Safe and effective health care delivery depends on well-designed, maintained, and operational health care facilities (HCF). HCFs provide the backbone to deliver the best standard of treatment. Presenters will describe how the new edition of Z8002 addresses risk management, the continuity of operations, and emergency preparedness plans that enable infrastructure improvements for HCFs. The new edition of Z8002 also addresses technological advances in building, monitoring, energy optimization, and measures to increase sustainability and performance.	
1030-1100	Refreshment Break in Exhibit Hall Sponsored by Belimo Canada SILVER SPONSOR	Grand Salon (TCU)
1100-1200	TWO CONCURRENT TRACKS 2A & 2B	
TRACK 2A	Benefits of Using RETScreen Clean Energy Management Software in Health Care	Gallery A (TCU)
Speakers:	Kevin Bourque , Project Engineer, RETScreen International, Natural Resources Canada CanmetENERGY Research Centre, Varennes QC JJ Knott , CET, CCHFM, CEM, CDSM, Project Lead, Healthcare Energy Leaders Ontario, Simcoe	
Moderator:	Peter Whiteman , A/Director Facilities Operations and Maintenance, Regina Qu'Appelle Health Region, Regina, SK	
CCHFM Core Competency: Finance Management	Developed in Canada, RETScreen Software is relatively new to the health sector but is recognized for its potential to empower energy professionals and decision-makers rapidly identify, assess and optimize the technical/financial viability of potential clean energy projects, and assist in improving a facility's climate change impact resiliency. RETScreen also allows managers to easily measure and verify the actual energy performance of their facilities and help find additional energy savings opportunities.	
TRACK 2B	The Building Envelope: Keeping the Water Out Sponsored by CHES Ontario Chapter GOLD SPONSOR	Gallery B (TCU)
Speaker:	Gord Rajewski , National Practice Leader for the Building Science and Sustainability (BSS) Group, Pinchin Ltd.	
Moderator:	Jim McArthur , Director, Properties, Albright Manor, Beamsville, ON	
CCHFM Core Competency: Maintenance & Operations	This presentation will provide an overview of the common sources of air and water infiltration, and associated impacts to the building and health/comfort of the individuals in the building. Appropriate management and understanding of the building envelope which can help provide better health outcomes for patients, comfort level for staff and long term cost savings through energy efficiency and building repair.	
1200-1400	Lunch in the Exhibit Hall Sponsored by AquaAnalytics PLATINUM SPONSOR	Grand Salon (TCU)
1400-1500	TWO CONCURRENT TRACKS TRACK 3A & 3B	
TRACK 3A	CSA Healthcare Standards: How Compliant Are You? Sponsored by Abatement Technologies SILVER SPONSOR	Gallery A (TCU)
Speaker:	George Pankiw , PEng, CCHFM, SASHE, CHFM, Site Manager, Facilities Management, Hamilton General Hospital, Hamilton	
Moderator:	Gordon Burrill , President, Teegor Consulting Inc., Fredericton, NB	
CCHFM Core Competency: Code Compliance	At Hamilton Health Sciences, the Facilities Management department has created a scorecard based on the CSA standards applicable to healthcare operations and maintenance. The scorecard allows you to get an overall view of your compliance ratings against each standard. In this presentation we will look at the development of the scorecard, review some of the ratings, review our plans for improvement and discuss progress to date. At the end of this session, participants will be able to	
	1. Identify O&M requirements of the CSA standards applicable to Healthcare	

MONDAY, SEPTEMBER 23, 2019

2. Carry out an assessment of compliance to the CSA standards applicable to Healthcare
3. Visualize the assessment to see where their strengths and weaknesses are

TRACK 3B

Deciphering Electric Lighting Technology

Gallery B (TCU)

Speaker: **Alison White**, Asspc. IALD, MIES, LC, Certified Lighting Consultant, SMP Lighting Group

Moderator: **Steve Kemp**, Vice President, Ritenburg & Associates, Regina, SK

CCHFM Core

Competency: PDC,
Code Compliance

The presentation will offer guidelines to evaluate lighting and control systems for healthcare applications and clarify some common misnomers including an overview of future trends. We will look at lighting and controls design and what make sense for the application. It will review budgets restraints, product life cycle and a case study of a 144 bed senior residence lighting upgrade.

Session Objectives:

1. Demystify lighting and to understand how lighting effects occupants of the built environment.
2. To provide the attendees with tools to ask the right questions to ensure lighting systems they asked or are what they get.
3. To identify resolve lighting challenges faced when designing for both new construction and retrofit.

1500-1600

TWO CONCURRENT TRACKS TRACK 4A & 4B

TRACK 4A

CSA Z7396.1-17 Medical Gas Pipeline Systems: A need to know discussion Sponsored by RWC. BRONZE SPONSOR

Gallery A (TCU)

Speakers: **Roger Holliss**, MEng, Director of Engineering & Biomedical Services, St. Mary's Hospital, Kitchener

Alan Pinkerton, President, PMG Systems Ltd., East York, ON

Moderator: **Gordon Burrill**, President, Teegor Consulting Inc., Fredericton, NB

CCHFM Core

Competency: Code
Compliance

The fourth edition (2017) of CSA Z7396.1 is a foundation standard and installation code for medical gas systems within health care facilities, and is substantially changed/improved from the withdrawn 2012 edition. Best practice always suggests following the latest standard, regardless of the AHJ adoption status. From our technical sub-committee perspective, including incident knowledge, we'll focus on the new Clause 15 Maintenance and Ongoing Verification section. Of significance are new 'appointed' Qualified Operator designations. 'Need to know' material for all operators, and anyone touching the system that's ever wondered or questioned whether/what they can. Learn how to become qualified. Lives depend on actions, and an understanding of daily responsibilities.

TRACK 4B

Finding the Sweet Spot in Long Term Care Sponsored by CHES MB Chapter. BRONZE SPONSOR

Gallery B (TCU)

Speakers: **Jerold Peters**, Architect, AAA, AIBC, MAA, OAA, SAA, FRAIC, LEED AP, Principal, ft3 Architecture Landscape Interior Design

Chris Ott, PEng, Principal, Senior Mechanical Engineer, SMS Engineering, Winnipeg

Chris Hewitt, BEng (Hons), PEng, CEng (UK), MIET, LEED AP, President, Senior Electrical Engineer, SMS Engineering, Winnipeg

Moderator: **Reynold Peters**, Manager, Construction/Energy Management, Southern Health-Sante' Sud, Steinbach, MB

CCHFM Core

Competency:
Planning Design &
Construction

Long term care is neither hospital nor seniors housing. In our efforts to de-institutionalize long term care environments and reduce capital costs are we appropriately addressing infection control, levels of care required, performance of systems and robust infrastructure? What is that sweet spot? This session will explore codes and standards in current design thinking to create home-like environments, ultimately improving outcomes for residents.

1600-1700

"Happy Hour" in the Exhibit Hall Sponsored by Trane GOLD SPONSOR

Grand Salon (TCU)

MONDAY, SEPTEMBER 23, 2019

COMPANION PROGRAM

1000-1600

Sponsored by IEM SILVER SPONSOR

Bus Pickup – Meet in the Lobby of the Saskatoon Arts & Convention Centre, TCU Place at 9:45 AM
Following the Keynote

PRESIDENT'S RECEPTION AND BANQUET

Reception – Centennial Hall ABC Foyer, Saskatoon Arts & Convention Centre, TCU Place
Banquet – Centennial Hall ABC, Saskatoon Arts & Convention Centre, TCU Place

PRESIDENT'S RECEPTION

1800-1900

Reception – Centennial Hall ABC Foyer, Saskatoon Arts Convention Centre, TCU Place

Sponsored by Tremco Canada PLATINUM SPONSOR



President's Reception Entertainment – Don Griffith

Sponsored by Armstrong Fluid Technology

MONDAY, SEPTEMBER 23, 2019

GALA BANQUET AND PRESENTATION OF CHES AWARDS

1900-2300

Banquet – Centennial Hall ABC, Saskatoon Arts & Convention Centre, TCU Place

Sponsored by Johnson Controls Inc. DIAMOND SPONSOR



ENTERTAINMENT

Sponsored by CHEM-AQUA DIAMOND SPONSOR



Gala Banquet Entertainment



JACK SEMPLE

TUESDAY, SEPTEMBER 24, 2019

0700-0830	Delegate Breakfast <i>Sponsored by SMP Engineering GOLD SPONSOR</i>	Gallery CD (TCU)
0830-0900	CHES Board/Exhibitor Meeting	
0830-0930	TWO CONCURRENT TRACKS TRACK 5A & 5B	
TRACK 5A	Fire Safety Evaluation Systems and Their Role in Asset Management <i>Sponsored by CHES Ontario GOLD SPONSOR</i>	Gallery A (TCU)
Speaker:	Ben Coles , MScE, MBA, PEng, PE, Fire Protection Engineer, RJ Bartlett Engineering Ltd., Fredericton NB	
Moderator:	Jim McArthur , Director, Properties, Albright Manor, Beamsville, ON	
CCHFM Core Competency: Code Compliance	Application of contemporary building code requirements within existing Healthcare facilities is not always practical. The Canadian Hospital Fire Safety Evaluation System (CHFSES) is a quantitative method for ranking fire and life safety that enables cost effective and prioritized upgrades, and is central to the realm of asset management.	
TRACK 5B	Disrupting the Building and Infrastructure Industry	Gallery B (TCU)
Speakers:	Sunny Ghataurah , PEng, PE, CLD, CTS, LEED AP BD+C, President, AES Engineering Ltd., Vancouver BC	
Moderator:	Roger Holliss , Director of Engineering & Biomedical Services, St. Mary's General Hospital, Kitchener, ON	
CCHFM Core Competency: Planning Design & Construction	"If you don't understand technology, you will be replaced by it." Looking through the lens of technology, Sunny will explore the evolution of the design and construction industry, demonstrating how emerging technologies have and continue to trigger revolutions in the way that we live, work, and heal people in modern healthcare facilities.. Technologies discussed will range from the switchboard to quantum computing, pinsetting to automated transportation, coal-fired electricity to electric vehicles, and manual drawing production to Building Master Systems Integration.	
0930-1015	CHES NATIONAL ANNUAL GENERAL MEETING	Gallery A (TCU)
1015-1045	Refreshment Break in Exhibit Hall <i>Sponsored by TIAC BRONZE SPONSOR</i>	Grand Salon (TCU)
10:15-10:45	CHES Saskatchewan Chapter Annual General Meeting	
1015-1315	TRADESHOW OPEN	Grand Salon (TCU)
1215-1315	LUNCH IN EXHIBIT HALL & EXHIBITOR PRIZE DRAWS	Grand Salon (TCU)
1315-1415	TWO CONCURRENT TRACKS 6A & 6B	
TRACK 6A	Co-generation as a Resiliency Measure	Gallery A (TCU)
Speaker:	John Karman , CTech, PMP, RSW, LEED AP, BD+C, Senior Project Director, SMP Engineering, Edmonton AB	
Moderator:	Preston Kostura , Facilities Maintenance & Engineering, Director, Central Zone Alberta Health Services, Camrose AB	
CCHFM Core Competency: Planning Design & Construction / Finance Management	The presentation will present a case study in electrical system resiliency for the Edmonton Lab Hub. It will present the various resiliency options that were considered, and discuss the various solutions, and in particular the co-generation option that is being implemented and the reduced operating costs and carbon footprint for this 47,000 square meter.	

TUESDAY, SEPTEMBER 24, 2019

TRACK 6B	The "Heart" of Hospital Comfort - Improving Resiliency by Understanding Flow <i>Sponsored by CHES Ontario Chapter GOLD SPONSOR</i>	Gallery B (TCU)
Speaker:	Yves Lemoine , BASc, PEng, Director, Energy Upgrades Canada, Armstrong Fluid Technology, Toronto ON	
Moderator:	Christa Brown , Marketing Manager, AquaAnalytics, Mississauga, ON	
CCHFM Core Competency: Finance Management / Planning Design & Construction	Patient and staff comfort, building resilience, operating risk and return on investment are at odds when managing operating requirements, deferred maintenance and capital upgrades. This presentation will demonstrate that by starting with the pumps, the "heart" of the hospital, that these objectives can be aligned and result in deep improvements in comfort, reduced risk, and enhanced energy performance of up to 40%. It empowers the HVAC system to be resilient to changing functionality of the hospital.	
1415-1515	TWO CONCURRENT TRACKS 7A & 7B	
TRACK 7A	The Importance of Building an IPAC Culture to Improve Patient Care and Outcomes <i>Sponsored by Abatement Technologies SILVER SPONSOR</i>	Gallery A (TCU)
Speaker:	Craig Yee , BSc, MSc (OEH), CRSP, AHERA, Master Trainer, Infection Control Training Group, Vancouver BC	
Moderator:	Peter Jarvis , Zone Director, Alberta Health Services, Smokey Lake, AB	
CCHFM Core Competency: Operations & Maintenance / Administration	Many organizations talk about the importance of establishing and maintaining a "culture." But why is this necessary in a healthcare environment regarding infection control? This session will describe some of the operational challenges and breakdowns in keeping patients safe, and why building and sustaining an IPAC culture – incorporating values such as collaboration, transparency, and positive interaction – is critical in maintaining, and even improving, patient safety and outcomes. This session will enable attendees to: <ol style="list-style-type: none">1. Understand and know the importance and critical aspects of an infection control culture.2. Identify and assess the challenges, obstacles and breakdowns that lead to culture differences.3. Provide practical, real world solutions in addressing culture issues and mitigating communication problems.	
TRACK 7B	Developing an Effective Scope of Work (SOW) for Operations and Service Contracts. <i>Sponsored by Acklands-Granger Inc. BRONZE SPONSOR</i>	Gallery B (TCU)
Speaker:	Dr. Jake Smithwick , PhD, MPA, Assistant Professor, Civil Engineering Technology and Construction Mgmt., The William States Lee College of Engineering, UNC Charlotte	
Moderator:	Steve Kemp , Vice President, Ritenburg & Associates, Regina, SK	
CCHFM Core Competency: Administration	Developing a clear Scope of Work (SOW) can be challenging. Some SOWs may be vague or lack critical details. Others have requirements that are overly prescriptive and can limit vendor innovation. Results from twenty years of procurement research will showcase how poor SOWs create a "tumbling dominoes" effect that brings risk to the owner. This presentation will identify the (surprisingly simple!) elements of an effective SOW. Templates for developing SOWs will be provided, along with discussion of how to increase vendor innovation during the bidding process. Tangible examples from a variety of facility contracts and construction projects will be shared (e.g., custodial, maintenance, design/construction, waste management, business services, and more).	
1515-1545	Refreshment Break <i>Sponsored by Camfil Canada SILVER SPONSOR</i>	Grand Salon (TCU)
1545-1645	TRACK 8	
	The National Trend Toward Prompt Payment - How Will This Impact Consultants?	Gallery AB (TCU)
Speakers:	Misty Alexandre , BA (Hons), Juris Doctor, Lawyer/Partner, Robertson Stromberg LLP, Saskatoon SK Jared Epp , BA (Psych), Great Distinction, Juris Doctor, Lawyer/Partner, Robertson Stromberg LLP, Saskatoon SK	

TUESDAY, SEPTEMBER 24, 2019

Moderator: **Peter Whiteman**, *A/Director Facilities Operations and Maintenance, Regina Qu'Appelle Health Region, Regina, SK*

CCHFM Core Competency: Finance Management
A presentation outlining the requirements of the recent prompt payment legislation introduced in Saskatchewan in the fall of 2018. Similar to the prompt payment legislation introduced in Ontario, this legislation will have major impacts on consultants in the healthcare industry when administrating construction contracts for new or renovated facilities.

1645-1700

Closing Ceremonies

Gallery AB (TCU)

Moderator: **Jim Allen**, *Vice President, Five Hills Health Region, Moose Jaw, SK*
Steve Kemp, *Vice President, Ritenburg & Associates, Regina, SK*

SPEAKERS

Misty Alexandre:



Misty was called to the Bar in 2007 and became a partner with the firm in 2012. She specializes in the area of construction law and commercial debt recovery.

Misty advises and represents suppliers, contractors, subcontractors, consultants and owners on all aspects of the construction project, including procurement issues, contract drafting and enforcement, builders' liens and dispute resolution/arbitrations.

Misty was recently added to the 2019 Edition of Best Lawyers in Canada, a peer review publication, in the area of Construction Law.

In 2018, Misty served as Chair of the Canadian Bar Association Construction Law Section (Saskatchewan Branch).

Some of Misty's recent involvement in the construction industry includes:

- Article for We Build Magazine -"What Can Contractors Expect from Prompt Payment Legislation?" (Fall 2018)
- Prompt Payment Legislation Presenter for SCA Saskatoon Construction Entrepreneurs Roundtable (September 2018)
- Presenter for Saskatchewan Construction Association Annual Summer Meeting (2016-2018)
- Prompt Payment Panel Member at Saskatchewan Construction Association Annual Summer Meeting (2018).
- Education Session Presenter for General Contractors Association Annual Golf Tournament (2017-2018)
- Executive committee member for Construction Specifications Canada (Saskatoon Chapter) (2015-2018)
- Course Instructor for Great West Plains College Construction Management Essentials course (2015)
- Presenter for Canadian Healthcare Engineering Society Annual Conference (2015-2017)

Robert Barss:



Robert is Manager of Environmental Stewardship with the Nova Scotia Health Authority based out of Bridgewater, Nova Scotia. He previously held the position of Director of Engineering and Maintenance for 3 hospitals on the South Shore of province. Prior to joining healthcare in 2003 he was a senior

supervisor with the Engineering and Maintenance department of Highliner Foods.

Robert is a Certified Engineering Technician and hold trade certifications in the marine, industrial, and construction electrical field. He has achieved the professional designations of Canadian Certified Healthcare Facilities Manager (CCHFM), through the Canadian Healthcare Engineering Society and Certified Healthcare Facility Manager (CHF), through the American Hospital Association and the American Society of Healthcare Engineers.

Robert has held various positions within the Canadian Healthcare Engineering Society and is presently Vice Chair of the Maritime Chapter, Chair of the National Professional Development Committee and Chair of the Advisory Panel overseeing the certification program for CCHFM.

Mark Black:



Born with a life-threatening heart defect, Mark underwent two open-heart surgeries before the age of one. His parents were told to expect more surgeries before he started school. Mark was not expected to live a long life.

He battled his condition and it's limitations successfully for twenty-two years before having to face the biggest challenge of his life. Mark's doctor informed him that his heart was failing badly and that without a rare and dangerous heart and double-lung transplant, he would not likely see his 25th birthday.

In October 2001, Mark moved thousands of kilometres from home and was put on the transplant waiting list. After just four months on the list, Mark's condition grew worse and he was placed in the hospital where he lived on the precipice of life and death, for 6 months.

Finally, by the grace of God, on September 7th, 2002, after almost a year on the list, Mark received a second chance at life: a life-saving Heart & Double-Lung Transplant.

The average lifespan of someone with his transplant is 5-10 years. It's been 16 years since Mark's transplant. He is in his 40s. It is very unlikely Mark will live to see his 50's. This is what makes his message so powerful. He lives the strategies and principles he teaches and he is filled with

SPEAKERS

passion and purpose for his work precisely because he doesn't know how much more time he'll be afforded to do it.

Since receiving his second chance at life Mark hasn't wasted a moment. After meeting the love of his life, Marise, the two married, and they have 3 healthy children. Mark has travelled the globe speaking to more than 150,000 people.

Mark lives in Moncton, New Brunswick, Canada where he spends as much time as possible with the most important people in his life; his wife Marise and their three children Emma, Matteo, and Caleb

Kevin Bourque:



Kevin Bourque is part of the outreach and support team of the RETScreen Clean Energy Management Software at Natural Resources Canada's CanmetENERGY research centre in Varennes, Quebec. He's been involved with every aspect of RETScreen, including development of the power, industrial, commercial, institutional and residential

archetypes; helping customers use the software; delivering training seminars and workshops; developing online distance learning tools such as the eLearning channel, e-Textbook and case studies; and even prototype software development. Prior to joining NRCan, Kevin worked as a wind energy consultant specializing in the assessment, computer modelling and performance analysis of wind energy systems. He has been working in the energy field since 1999. Kevin obtained a Bachelor of Engineering degree (Mining Engineering) from McGill University.

Ben Coles:



Ben Coles is a Project Coordinator at RJ Bartlett Engineering Ltd in Fredericton, New Brunswick. Ben is a licensed Professional Engineer in New Brunswick, Newfoundland, Prince Edward Island, and Maine. Ben graduated as a mechanical engineer in 2003 from the University of New Brunswick (UNB) and has since completed his M.Sc.E. in Fire Protection

Engineering from Worcester Polytechnic Institute (WPI) in

2009 and MBA in Engineering Management from UNB in 2011.

Ben has participated on a variety of committees with organizations such as the Society of Fire Protection Engineers (SFPE), Association of Professional Engineers and Geoscientists of New Brunswick, and the Association of Consulting Engineering Companies.

Ben provides fire protection consulting services on all types of occupancies and has been involved in over one hundred Fire and Life Safety Evaluations of Health Care facilities across Canada.

Jared Epp:



Jared is a partner with Robertson Stromberg LLP, a firm where he has worked since 2012.

Jared provides expertise in the area of construction and insurance law. He advises and represents companies, firms and individuals on all aspects of the construction process with a focus on dispute resolution. He has successfully represented construction clients in both Saskatchewan and Manitoba, including in relation to the expansion of the Winnipeg Airport, a multi-million-dollar lawsuit, involving dozens of trades and consultants.

Jared is an executive committee member of Construction Specifications Canada (Saskatoon Chapter), Canadian Bar Association and also serves as treasurer for the Saskatchewan Trial Lawyers Association. In 2018, Jared became the Vice-Chair for the Canadian Bar Association's Construction Law section (Saskatchewan chapter).

In 2017, Jared developed a fully accredited university course in Construction Law for the University of Saskatchewan, and currently serves as the sessional lecturer for the course.

Jared has presented to, among others, the Saskatoon Construction Association, Canadian Bar Association, Saskatchewan Trial Lawyers Association, and the Canadian Healthcare Engineering Society including on builders' liens, insuring the construction project, and resolving construction disputes. His recent experience in the construction industry includes:

- Article for We Build Magazine - "Prompt Payment - What's in the Bill?" (Winter 2018)
- Course Presenter for Construction 101 - Saskatoon Construction Association (2016-2018)
- Presenter at Canadian Bar Association National Construction and Infrastructure Law Conference (2018)

SPEAKERS

- Presenter for Canadian Healthcare Engineering Society Annual Conference (2018)
- Presenter for SCA Construction Week (April 2017)
- National Bank v. KNC Holdings. Acting on behalf of a number of contractors, Jared challenged the priority position of a bank in an insolvency proceeding. KNC Holdings is the leading decision in Saskatchewan in relation to builders' lien claims in insolvency proceedings.
- Grey Owl Engineering v. Propak Systems. As counsel for a procurement firm, Jared challenged the ability of a lien claimant to lien a modular oil extraction system. Propak is the leading decision in Saskatchewan on the meaning of improvement in the context of The Builders' Lien Act.

Sunny Ghataurah:



Ben Coles is a Project Coordinator at RJ Bartlett Engineering Ltd in Fredericton, New Brunswick. Ben is a licensed Professional Engineer in New Brunswick, Newfoundland, Prince Edward Island, and Maine. Ben graduated as a mechanical

engineer in 2003 from the University of New Brunswick (UNB) and has since completed his M.Sc.E. in Fire Protection Engineering from Worcester Polytechnic Institute (WPI) in 2009 and MBA in Engineering Management from UNB in 2011.

Ben has participated on a variety of committees with organizations such as the Society of Fire Protection Engineers (SFPE), Association of Professional Engineers and Geoscientists of New Brunswick, and the Association of Consulting Engineering Companies.

Ben provides fire protection consulting services on all types of occupancies and has been involved in over one hundred Fire and Life Safety Evaluations of Health Care facilities across Canada.

Chris Hewitt:



Chris Hewitt, an electrical engineer who has led teams for several of Manitoba's largest healthcare redevelopment projects including those for the Health Sciences Centre, St. Boniface Hospital, Grace Hospital and Holy Family Personal Care Home.

Roger Holliss:



Roger Holliss (P. Eng) is the Director of Engineering, Redevelopment, Bio-Medical Services, Parking & Security for St. Mary's General Hospital in Kitchener Ontario. St. Mary's is a medium sized acute care hospital, and also cardiac center for the south-western Ontario region. Over the 18 years in healthcare, Roger has increased his influence both within his hospital and healthcare engineering as he transitioned through a number of CHES roles including the CHES Ontario Chapter Chair to his current position as CHES National's Vice President. As it relates to the CSA Medical Gas standard, Roger fulfills multiple roles as both an end user for St. Mary's, a representative of CHES on this standard and the Medical Gas technical sub-committee's vice chair. As such, he brings a number of perspective to the unique CSA healthcare standard that is medical gases and piping systems.

John Karman:



John Karman, C.Tech, PMP, LEED AP BD+C, TMIET John has been in the consulting industry for over 30 years. Throughout his career he has had the privilege to work on large and complex institutional projects throughout North America and the Middle East. As a Senior Projects Director with SMP Engineering, John is responsible for leading the electrical team on highly complex and large projects in Healthcare, Laboratory and Educational facilities. John is passionate about planning Electrical Infrastructure that is flexible, scalable and resilient. Recent projects that John has been involved with include the New Cancer Centre in Calgary Alberta and the 425 bed King Faisal Tertiary Care Hospital in Riyadh KSA. Current projects include the 470,000 square foot Edmonton Lab Hub and the 350 bed Norwood Continuing Care Centre, both located in Edmonton Alberta. John graduated from MTS Vlissingen in the Netherlands, and is a certified Project Management Professional, Registered Specification Writer and LEED Accredited Professional specializing in the Building Design and Construction.

SPEAKERS

JJ Knott



JJ works tirelessly to inspire colleagues in health care facilities across Canada to embrace energy efficiency practices and to incite them to make energy management an integral part of their facility management protocols.

He helped develop the concept, framework and delivery model of the HealthCare Energy Leaders Canada (HEL-C) program. JJ worked for years within the HELO framework to identify energy conservation measures, deliver training, and follow-up on opportunities for sites across Ontario, ensuring that projects were planned and budgeted for, as well as implemented. For over 2 decades he served as the Director of Plant Operations, and Project Manager at Norfolk General Hospital. JJ also played an instrumental role in helping Norfolk attain the 2012 OHA/Coalition Green Award for Overall Leadership and the 2008 Wayne McLellan Award from CHES for energy and environmental stewardship accomplishments.

J.J. helped develop the Green Revolving Fund (GRF) pilot initiative so that healthcare facilities across Ontario could benefit from funds raised through the carbon cap and trade program. JJ has taught hospital building performance courses (such as the Building Operators Certification Course through the Canadian Institute for Energy Training) and is actively involved in improving the sustainability of Ontario Hospitals. In recognition of his accomplishments he was the recipient of the 2014 Green Health Care Individual Leadership Award. J.J. has also given course instruction in the Hospital Building Systems course, offered through Seneca College.

Between 2011-2013, JJ acted as President for the Canadian Healthcare Engineering Society (CHES) involving over 1000 members across Canada. JJ has remained a dedicated member of CHES for almost 3 decades, and is also a member of the Association of Energy Engineers (AEE). He is Vice-chair of the Canadian Coalition for Green Health Care (CCGHC) and a member of the CCGHC's National Energy Advisory Committee. He has also assisted the Coalition, and their partners, in the lobbying of senior levels of government to look at alternatives to conventional financing models that bring an environmental stewardship slant to the funding of energy and infrastructure renewal projects. Furthermore, he has helped create awareness with decision makers across Ontario and Canada, including the Ontario Environment Commissioner, Energy Canada, and others.

JJ was also past Chair of a local distribution company where he provided guidance which he has now brought to his position as HEL-C Project Lead, where he is an authority on hospital power needs and how health care facilities interact with energy supply companies.

Steve McEwan:



Steve McEwan is a Facilities Manager with BC's Interior Health Authority. He is a graduate of BCIT's Power and Process Engineering Program and holds qualifications in Power Engineering as well as being a journeyman Carpenter.

Steve has worked in Healthcare Facilities, Maintenance and Operations for over 33 years with the last 20 years in Facility Leadership Roles with the Fraser, Vancouver Coastal and Interior Health Authorities of BC. In addition to managing facility operations, Steve is involved in planning and managing facility renovations and infrastructure upgrades including ERs OR's, DI, emergency power, HVAC, medical gas systems and fire life & safety systems. Steve currently chairs the CSA Z8002 technical subcommittee and is the Past Chair of the CHES BC Chapter.

Chris Ott:



Chris Ott, a mechanical engineer experienced in new healthcare facilities in remote locations including God's Lake and Poplar Hill First Nation. Chris also works extensively with regional health authorities throughout Manitoba to assisting them in making informative decisions for their on-going capital planning projects.

SPEAKERS

George Pankiw:



George graduated from Royal Military College of Canada. He spent twenty years in the Canadian Forces as a Military Engineer in various roles. George then began working in healthcare and has worked at several Hospitals in Ontario. He is registered Professional Engineer in the Province of Ontario, and holds both the Canadian Certified Healthcare Facility

Manager from CHES and the Certified Healthcare Facility Manager Designation from the AHA, the first in Canada to do so.

He has been actively involved in both CHES and ASHE for the past 15 years. He is now a member of the Canadian Certified Healthcare Facility Manager Certification Advisory Panel and the Canadian Healthcare Construction Course Sub Committee. He is a member of the Technical Sub Committee for CSA Z8002 Operation & Maintenance of Healthcare Facilities. George is an instructor for the CSA Z317.13 standard on Infection Control in construction, renovation, Maintenance and repair and the CHES Canadian Healthcare Construction Course.

Jared Peters:



Jerald Peters is the Principal-in-Charge at ft3 Architecture Landscape Interior Design in Winnipeg, MB. With a Master of Architecture from the University of Manitoba, he has over two decades of experience as a

healthcare architect. His particular experience encompasses Emergency Department design, acute care, geriatric care, and hospital functionality and efficiencies. His passion for healthcare design began with his graduate thesis on personal care homes which has continued ever since. As Principal-in-Charge at ft3, he has led his team on significant projects such as a new Emergency Department for the Grace General Hospital, the Brian Sinclair Inquest Emergency Department Feasibility Study, and several innovative Personal Care Homes currently in the works. Jerald is a LEED accredited professional, holds a license to practice in five provinces, and is a Member of the College of Fellows, Royal Architectural Institute of Canada.

Alan Pinkerton:



Alan R. Pinkerton, President of Ontario based PMG Systems Ltd., specializes within Section 15, Ongoing Maintenance & Verification, including qualified training, technical repairs, testing and upgrades of Medical Gas Distribution Systems across Canada, now for 30+ years. Through his TSC member

work on the CSA Medical Gas Standard Z7396.1, Alan also uniquely contributes to related healthcare standards including hoses, MSUs, regulators etc., witnessing risks, failures and solutions everyday to support standards development. Member of the original CSA Z305.13 Standard on Plume Scavenging in Surgical, Diagnostic, Therapeutic, and Aesthetic Settings, and a TSC member of the upcoming new Z317.12 Cleaning and Disinfection of Health Care Facilities standard, Alan combines his passion of 'clean air for all' with HAI reductions as President and CEO of Radic8 Canada, providers of certified healthcare air disinfection technologies.

Jake Smithwick:

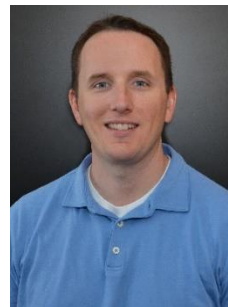

Dr. Jake Smithwick is a professor at the University of North Carolina in Charlotte. His research focuses on organizational performance benchmarking within healthcare, facility management, business services, and the broader built environment. His industry experience also includes field inspection of nearly 2,000

waterproofing systems (74 million square feet) across the United States, and six years in the US Air Force Reserve (civil engineering squadron).

Alison White:



Alison White Assoc. IALD, MIES, IDA, LC, presently with the Lighting Group at SMP Engineering in Calgary AB, spent most of her career in eastern Canada, relocating to Alberta 11 years ago. Her education is Architectural; however, her experience

SPEAKERS

started in electrical design but has specialized in architectural lighting for over 25 years.

Alison has been an instructor and guest lectured at several university programs in Architectural, Interior Design and Electrical Engineering. She presented at the ESCC 2018 – 5th International Conference on Energy, Sustainability and Climate Change in Mykonos, Greece, on LED Lighting Systems and Energy Savings. She is a past present and an active volunteer with the IES Calgary Section.

Craig Yee:



Craig Yee has 19+ years of industry experience as an industrial hygienist and infection control expert. He is well known for his technical knowledge and skills, and practical approaches to assisting stakeholders with identifying and managing

their safety infection risks.

He has founded and manages both OHS Global Risk Solutions and the Infection Control Training Group, which provide infection control consulting services and practical certification and awareness training, respectively.

Craig has extensive experience in healthcare environments and has worked in dozens of facilities across Western Canada and the Territories. He is a member of the 2017 CSA Standard, Section 8. (New Construction Projects) Working Group Committee and actively participated in rewriting, revising, and adding various standards.

His goal is to help maintain and improve patient outcomes by educating, training, instructing various stakeholders in the proper and practical interpretation, use and application of infection prevention and control standards and principles. the Patient Safety Movement.
<http://ca.linkedin.com/in/barrywhunt>

The Canadian Healthcare Engineering Society would like to thank their 2019 sponsors:

KEY

Honeywell

DIAMOND



PLATINUM



GOLD



SILVER



BRONZE

